



# Assembly Instruction

## Art Stand

Audiodata Salzburg GmbH  
Pfungau Mitte 9  
5202 Neumarkt  
[www.audiodata.com](http://www.audiodata.com)

## Package content

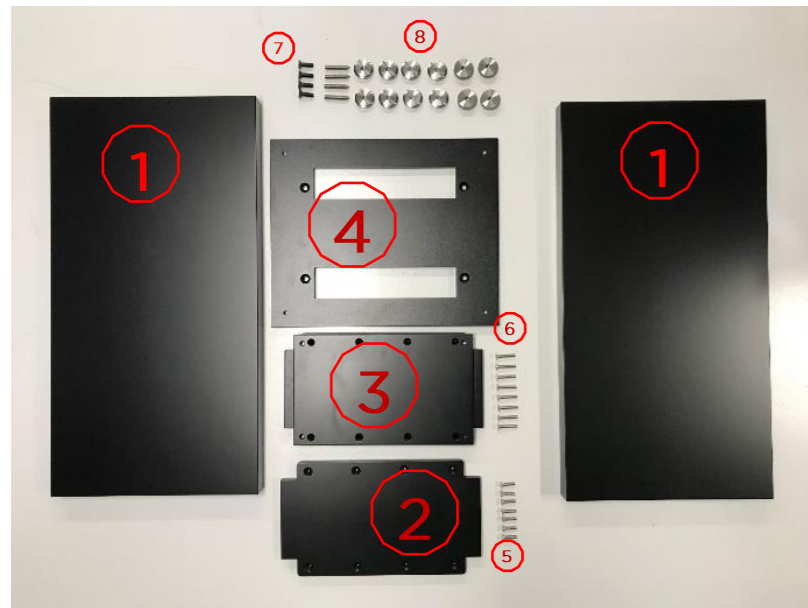

- 1 Side panel
- 2 Top plate
- 3 Base plate
- 4 base
- 5 Countersunk screw M6 x 25
- 6 Countersunk screw M6 x 35
- 7 Countersunk screw M8 x 20
- 8 Spikes



Connect the second side panel ① with the base plate ③ and the top plate ②

## Assembling the base plate and the top plate:

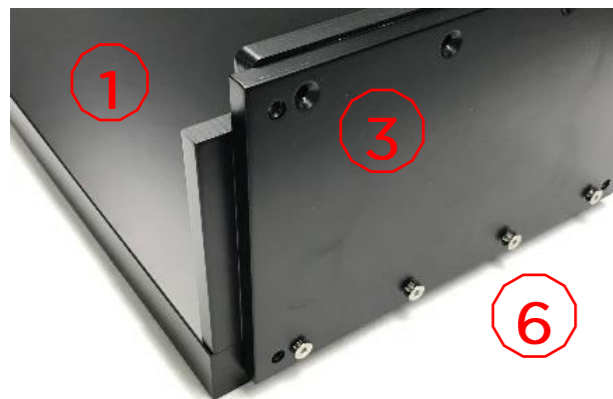

The baseplate ③ is connected with the side panel ① by using countersunk screw M6 x 35 ⑥

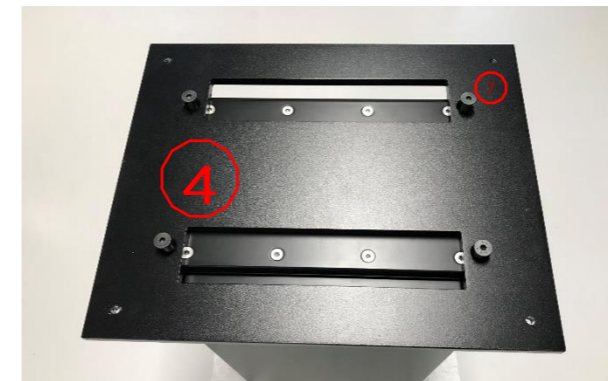

Assembling of the base ④ by using countersunk screw M8 x 20 ⑦

## Installation of spikes:

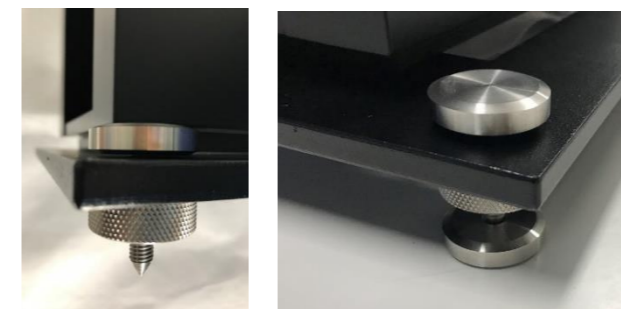

Assemble all parts of the spikes as you can see on the picture

⑧

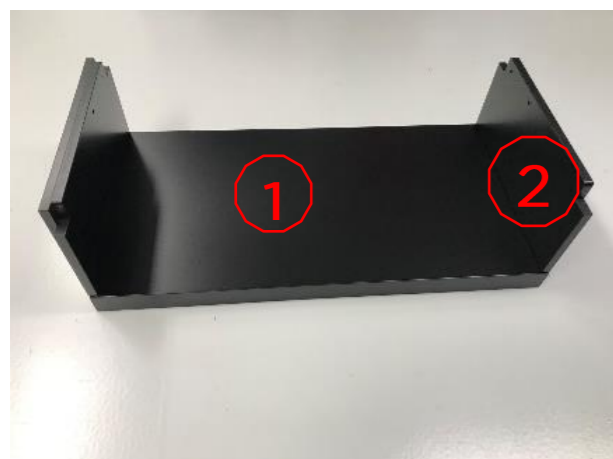

The top plate ② is connected with the side panel ① by using countersunk screw M6 x 25 ⑤

## Glue on enclosed felt:



Glue on enclosed felt as base for the spiker on the top plate.



The stability is heavily dependent on the nature and condition of the floor. Carpet floors can considerably reduce stability. The stability can be significantly improved by using the spikes supplied with the product. However, care is called for when fitting these, as there is a risk of injury from the sharp tips of the spikes and a possibility of damaging floor. Stands must under no circumstances be used as seats or climbing aids (ladder substitutes)